

ROTEX® Torsionally flexible couplings

please contact/bitte ansprechen:
as antriebstechnik gmbh
 Fon: +49 (0)40 / 679 467-0 Fax: +49 (0)40 / 679 467-20
 www.aunds-vertrieb.de

Shaft coupling design No. 001 - casted materials



- Torsionally flexible, maintenance-free
- Damping vibrations
- Axial plug-in, fail-safe
- Allow machining – good dynamic properties
- Compact design/small flywheel effect
- Finish bore according to ISO fit H7, feather keyway according to DIN 6885 sheet 1 - JS9
- Basic programme/stock programme see pages 24 and 25
- Approved according to EC Standard 94/9/EC (without aluminium AL-D)
- Mounting instructions under www.ktr.com

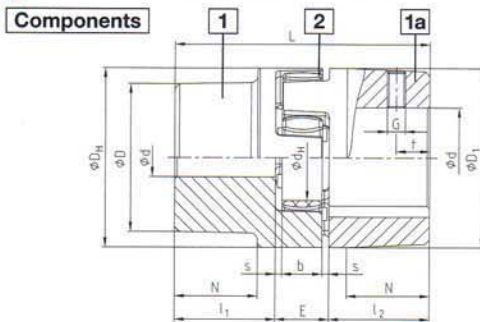

AL-D (thread opposite the keyway)

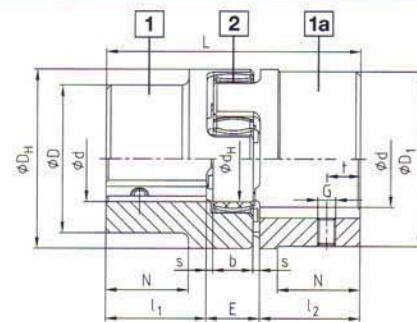

EN-GJL-250 / EN-GJS-400-15 (thread on the keyway)

ROTEX® Aluminium diecast (Al-D)																	
Size	Component	Spider (part 2) ¹⁾			Finish bore d (min-max)	Dimensions [mm]											
		92 Sh A	98 Sh A	64 Sh D		General										Thread for setscrews ²⁾	
					L	$l_1; l_2$	E	b	s	D_H	d_H	D; D_1	N	G	t	T_A [Nm]	
14 ³⁾	1a	7,5	12,5	-	6-16	35	11	13	10	1,5	30	10	30	-	M4	5	1,5
19	1	10	17	-	6-19	66	25	16	12	2	41	18	32	20	M5	10	2
	19-24				41												
24	1	35	60	-	9-24	78	30	18	14	2	56	27	40	24	M5	10	2
	22-28				56												
28	1	95	160	-	10-28	90	35	20	15	2,5	66	30	48	28	M8	15	10
	28-38				66												

ROTEX® Cast iron EN-GJL-250 (GG 25)																		
Size	Component	Spider (part 2) ¹⁾			Finish bore d (min-max)	Dimensions [mm]												
		92 Sh A	98 Sh A	64 Sh D		General										Thread for setscrews ²⁾		
					L	$l_1; l_2$	E	b	s	D_H	d_H	D; D_1	N	G	t	T_A [Nm]		
38	1	190	325	405	12-40	114	45	24	18	3	80	38	66	37	M8	15	10	
	1a				38-48								78					62
	1b				12-48								164					70
42	1	265	450	560	14-45	126	50	26	20	3	95	46	75	40	M8	20	10	
	1a				42-55								94					65
	1b				14-55								176					75
48	1	310	525	655	15-52	140	56	28	21	3,5	105	51	85	45	M8	20	10	
	1a				48-62								104					69
	1b				15-62								188					80
55	1	410	685	825	20-60	160	65	30	22	4	120	60	98	52	M10	20	17	
	1a				55-74								118					120
	1b				20-74								210					90
65	1	625	940	1175	22-70	185	75	35	26	4,5	135	68	115	61	M10	20	17	
	1a				65-80								135					-
	1b				22-80								235					100
75	1	1280	1920	2400	30-80	210	85	40	30	5	160	80	135	69	M10	25	17	
	1a				75-95								160					-
	1b				30-95								260					110
90	1	2400	3600	4500	40-97	245	100	45	34	5,5	200	100	160	81	M12	30	40	
	1a				90-110								200					-
	1b				40-110								295					125

ROTEX® Nodular iron EN-GJS-400-15 (GGG 40)																	
Size	Component	Spider (part 2) ¹⁾			Finish bore d (min-max)	Dimensions [mm]											
		92 Sh A	98 Sh A	64 Sh D		General										Thread for setscrews ²⁾	
					L	$l_1; l_2$	E	b	s	D_H	d_H	D; D_1	N	G	t	T_A [Nm]	
100	1	3300	4950	6185	50-115	270	110	50	38	6	225	113	180	89	M12	30	40
110	1	4800	7200	9000	60-125	295	120	55	42	6,5	255	127	200	96	M16	35	80
125	1	6650	10000	12500	60-145	340	140	60	46	7	290	147	230	112	M16	40	80
140	1	8550	12800	16000	60-160	375	155	65	50	7,5	320	165	255	124	M20	45	140
160	1	12800	19200	24000	80-185	425	175	75	57	9	370	190	290	140	M20	50	140
180	1	18650	28000	35000	85-200	475	195	85	64	10,5	420	220	325	156	M20	50	140

¹⁾ = Material marking that the calculation/order is based on if no material is mentioned in the order.

²⁾ From size 125 thread for setscrews on request.

³⁾ Material Al-H.

ROTEX® Torsionally flexible couplings

Please order here:
as antriebstechnik + spannsysteme
 tel.: 0049 40 679467-0, fax: 0049 40 679467-20

Shaft coupling design No. 001 - material steel



- Hubs from steel, specifically suitable for drive elements subject to high loads, e. g. steel mills, elevator drives, spline hubs, etc.)
- Torsionally flexible, maintenance-free, vibration-damping
- Axial plug-in, fail-safe
- Allover machining - good dynamic properties
- Compact design/small flywheel effect
- Finish bore according to ISO fit H7, feather keyway according to DIN 6885 sheet 1 - JS9
- Basic programme/stock programme see pages 38 and 39
- Approved according to EC Standard 94/9/EC (Explosion Certificate ATEX 95)
- Mounting instructions available

Components

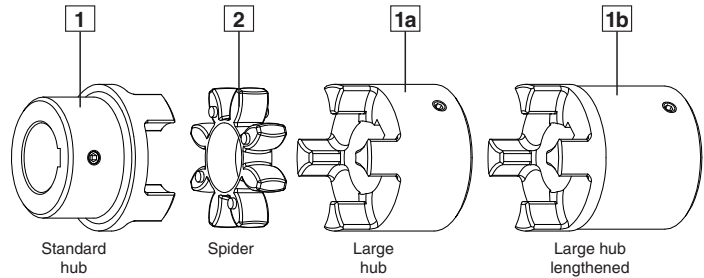
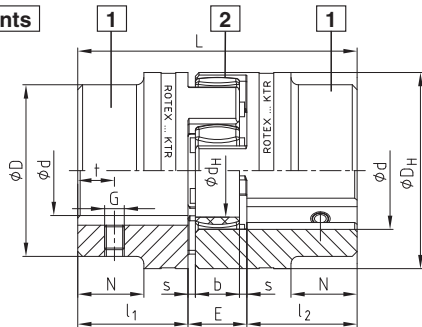

Steel (thread on the keyway)

ROTEX® steel																	
Size	Component	Spider (part 2) ¹⁾ Rated torque [Nm]			Finish bore d (min-max)	Dimensions [mm]											
						General						Spec. for steel		Thread for setscrews			
		92 Sh A	98 Sh A	64 Sh D		L	$l_1; l_2$	E	b	s	D_H	d_H	D	N	G	t	T_A [Nm]
19	1a	10	17	21	0-25	66	25	16	12	2	40	18	40	-	M5	10	2
	1b	90	37														
24	1a	35	60	75	0-35	78	30	18	14	2	55	27	55	-	M5	10	2
	1b	118	50														
28	1a	95	160	200	0-40	90	35	20	15	2,5	65	30	65	-	M8	15	10
	1b	140	60														
38	1	190	325	405	0-48	114	45	24	18	3	80	38	70	27	M8	15	10
	1b	164	70	80		-											
42	1	265	450	560	0-55	126	50	26	20	3	95	46	85	28	M8	20	10
	1b	176	75	95		-											
48	1	310	525	655	0-62	140	56	28	21	3,5	105	51	95	32	M8	20	10
	1b	188	80	105		-											
55	1	410	685	825	0-74	160	65	30	22	4	120	60	110	37	M10	20	17
	1b	210	90	120		-											
65	1	625	940	1175	0-80	185	75	35	26	4,5	135	68	115	47	M10	20	17
	1b	235	100	135		-											
75	1	1280	1920	2400	0-95	210	85	40	30	5	160	80	135	53	M10	25	17
	1b	260	110	160		-											
90	1	2400	3600	4500	0-110	245	100	45	34	5,5	200	100	160	62	M12	30	40
	1b	295	125	200		-											

ROTEX® sintered steel																	
Size	Component	Spider (part 2) ¹⁾ Rated torque [Nm]			Finish bore d	Dimensions [mm]											
						General						Thread for setscrews					
		92 Sh A	98 Sh A			L	$l_1; l_2$	E	b	s	D_H	d_H	D	N	G	t	T_A [Nm]
14	1a	7,5	12,5		unbored, 8, 10, 11, 12, 14	35	11	13	10	1,5	30	10	30	-	M4	5	1,5
19	1a	10	17		unbored, 14, 16, 19, 20, 22, 24	66	25	16	12	2	40	18	40	-	M5	10	2

▲ = If no material is mentioned in the order, the calculation/order is based on the material marked with

1) Maximum torque of the coupling T_{Kmax} = rated torque of the coupling T_{KNenn} x 2

ROTEX® 19 – 48 from stainless steel available from stock

- ROTEX® 19, 28 and 42 – hub material X10CrNiS 18-9 material number 1.4305 (V2A) DIN 17440

- ROTEX® 24, 38 and 48 – hub material X6CrNiMoTi17-12-2 material number 1.4571 (V4A) DIN 17440

Order form:

ROTEX®-38	St	92	1	-	Ø 45	1a	-	Ø 25
Coupling size	Material	Spider hardness Shore A]	Hub design		Finish bore	Hub design		Finish bore

ROTEX® Torsionally flexible couplings

please contact/bitte ansprechen:
as antriebstechnik gmbh
 For: +49 (0)40 / 679 467-0 Fax: +49 (0)40 / 679 467-20
 www.aunds-vertrieb.de

Shaft coupling design clamping ring hubs



- Torsionally flexible shaft coupling with integrated clamping system
- High smoothness of running, application up to a peripheral speed of 40 m/s
- For high friction torques (consider the selection in case of explosion protection use)
- Easy to assemble due to internal clamping screws
- Finish bore up to Ø 50 mm according to ISO fit H7, from Ø 55 mm according to ISO fit G7
- Approved according to EC Standard 94/9/EC (Explosion Certificate ATEX 95)

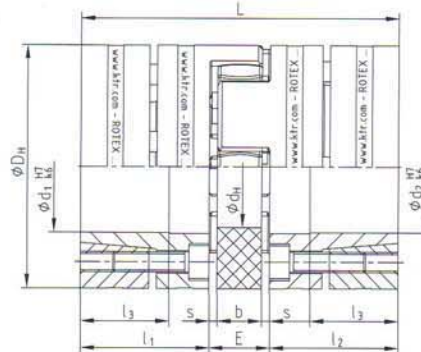

Tack thread
M₁ between
clamping
screws

Size	Torques [Nm] ¹⁾				Dimensions [mm]									Clamping screws			Weight per hub with max. bore [kg]	Mass moment of inertia per hub with max. bore [kg m ²]
	92 Sh A		98 Sh A		D _H ³⁾	d _H	L	l ₁ ; l ₂	l ₃	E	b	s	M	Number z	T _A [Nm]	M ₁		
	T _{KN}	T _{Kmax}	T _{KN}	T _{Kmax}														
				4) Hub material – Aluminium (Al-H) optionally steel									Clamping ring material – Steel (St-H)					
14	7,5	15	12,5	25	30	10,5	50	18,5	13,5	13	10	1,5	M3	4	1,34	M3	0,049	0,07 x 10 ⁻⁴
19	10,0	20	17	34	40	18	66	25	18	16	12	2,0	M4	6	3	M4	0,120	0,31 x 10 ⁻⁴
24	35,0	70	60	120	55	27	78	30	22	18	14	2,0	M5	4	6	M5	0,280	1,35 x 10 ⁻⁴
28	95,0	190	160	320	65	30	90	35	27	20	15	2,5	M5	8	6	M5	0,450	3,13 x 10 ⁻⁴
38	190,0	380	325	650	80	38	114	45	35	24	18	3,0	M6	8	10	M6	0,950	9,60 x 10 ⁻⁴
				Hub and clamping ring material – Steel (St-H)														
42	265	530	450	900	95	46	126	50	35	26	20	3,0	M8	4	35	M8	2,30	31,7 x 10 ⁻⁴
48	310	620	525	1050	105	51	140	56	41	28	21	3,5	M10	4	69	M10	3,08	52,0 x 10 ⁻⁴
55	375	750	685	1370	120	60	160	65	45	30	22	4,0	M10	4	69	M10	4,67	103,0 x 10 ⁻⁴
65	-	-	940 ²⁾	1880 ²⁾	135	68	185	75	55	35	26	4,5	M12	4	120	M12	6,70	191,0 x 10 ⁻⁴
75	-	-	1920 ²⁾	3840 ²⁾	160	80	210	85	63	40	30	5,0	M12	5	120	M12	9,90	396,8 x 10 ⁻⁴

1) Please note coupling selection on pages 104, 105, 117 2) Figures for 95 Sh A 3) ØD_H + 2 mm with high speeds for expansion of spider
 4) In case of using the spider 64 Sh D resp. short dimensioning we recommend the application of clamping ring hubs made of steel.
 Please note the technical details shown on page 104 and 116 with the use of the ROTEX GS spider.

Size	Bores d ₁ /d ₂ and the corresponding transmittable friction torques T _R of clamping ring hub in [Nm] ¹⁾																								
	Ø6	Ø10	Ø11	Ø14	Ø15	Ø16	Ø19	Ø20	Ø24	Ø25	Ø28	Ø30	Ø32	Ø35	Ø38	Ø40	Ø42	Ø45	Ø48	Ø50	Ø55	Ø60	Ø65	Ø70	Ø80
14	8,6	13,8	14,7	22,7																					
19		41	45	62	68	67	83	90																	
24			48	67	74	72	90	97	112	120	143														
28					142	154	189	188	237	250	280	307	310	353	389										
38								269	337	356	398	436	442	501	533	572	615	644							
42									399	445	506	470	566	581	647	630	728	836	858						
48											650	685	809	841	926	916	1042	1181	1125	1311					
55														918	954	1052	1040	1185	1220	1318	1359	1646	1662	1960	
65																1568	1569	1768	1833	1968	2049	2438	2495	2898	
75																		2246	2338	2500	2620	3082	3179	3657	4235

The transmittable torques of the clamping connection consider the max. clearance with shaft fit k6 / bore H7, from Ø55 G7/m6. With bigger clearance the torque is reduced.
 As shaft material – steel or spheroidal iron with a yield point of approx. 250 N/mm² or more can be used.
 If hollow shafts are used, the strength must be checked (see KTR mounting instructions, KTR Standard 45510 at our homepage www.ktr.com).

Order form:

ROTEX® 24	98 Sh A	6.0 – Ø 24	6.0 – Ø 20
Coupling size	Spider hardness	Hub design	Finish bore
		Hub design	Finish bore

ROTEX® Torsionally flexible couplings

Double-cardanic – the innovation in pump design

Type DKM No. 018

please contact/bitte ansprechen:
as antriebstechnik gmbh
 Fon: +49 (0)40 / 679 467-0 Fax: +49 (0)40 / 679 467-20
www.aunds-vertrieb.de



- For high shaft displacements
- 3-part double-cardanic
- Reduced vibration and noise
- The restoring forces resulting from displacements are very low
- Increase of the total lifetime of all adjacent components (bearings, seals etc.)
- Finish bore according to ISO fit H7, feather keyway according to DIN 6885 sheet 1 - JS9
- Approved according to EC Standard 94/9/EC (Explosion Certificate ATEX 95)
- Mounting instructions under www.ktr.com
- Double-cardanic design without the need for bearing support or external guarding

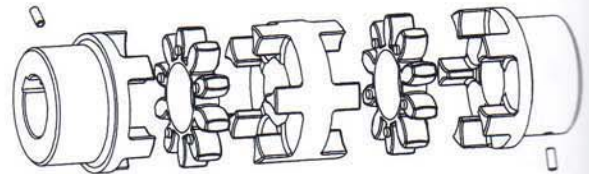
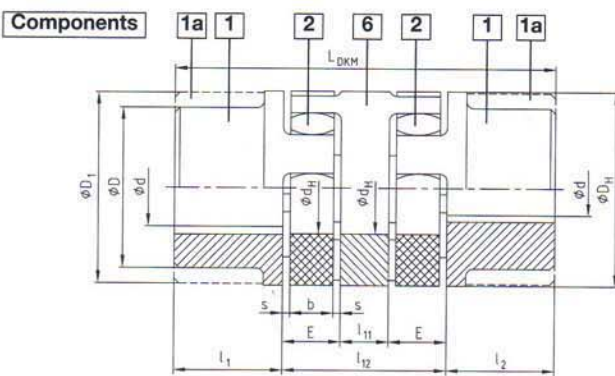

Type DKM

Size DKM	Pilot bore Ød ØD ØD1	Spider (part 2) Nominal torque [Nm]			Dimensions [mm]									Max. displacements at n = 1500 1/min		
		92 Sh-A	98 Sh-A	64 Sh-D	DH	dH	l1; l2	l11	l12	E	s	b	LDKM	Radial [mm]	Angular [°]	Axial [mm]
19	see shaft coupling page 26 and 27 standard range page 24 and 25	10	17	21	40	18	25	10	42	16	2	12	92	0,54	1,20	+1,2 / -1,0
24		35	60	75	55	27	30	16	52	18	2	14	112	0,53	0,90	+1,4 / -1,0
28		95	160	200	65	30	35	18	58	20	2,5	15	128	0,60	0,90	+1,5 / -1,4
38		190	325	405	80	38	45	20	68	24	3	18	158	0,77	1,00	+1,8 / -1,4
42		265	450	560	95	46	50	22	74	26	3	20	174	0,84	1,00	+2,0 / -2,0
48		310	525	655	105	51	56	24	80	28	3,5	21	192	1,00	1,10	+2,1 / -2,0
55		410	685	825	120	60	65	28	88	30	4	22	218	1,11	1,10	+2,2 / -2,0
65		625	940	1175	135	68	75	32	102	35	4,5	26	252	1,40	1,20	+2,6 / -2,0
75		1280	1920	2400	160	80	85	36	116	40	5	30	286	1,59	1,20	+3,0 / -3,0
90		2400	3600	4500	200	100	100	40	130	45	5,5	34	330	1,78	1,20	+3,4 / -3,0

Further type: ZS-DKM1



For detailed information please ask for our total data sheet no. M 369832.

Order form:

ROTEX®-38	DKM	EN-GJL-250	98	1 - Ø 38	1 - Ø 30		
Coupling size	Type	Material	Spider hardness [Shore A]	Component	Finish bore	Component	Finish bore