

FSO 300-700 FSO-GR 300-700 HPI 300-700



TYPE



FSO..GR

Types FSO, FSO-GR, and HPI 300 to 700 are sprag type freewheels self-contained, sealed and bearing supported, using two ball bearings.

Units are delivered oil or grease lubricated according to the type. It is a Formsprag USA design with a »full sprag complement« that gives a very high torque for a given

diameter. Any overload is resisted by a sprag to sprag abutment, avoiding a sprag tilt over. Types FSO and HPI are oil lubricated and use standard shaft lip seals. Type FSO-GR is grease lubricated and can be equipped with contact free labyrinth seals. Type HPI is specially designed for high speed indexing applications.

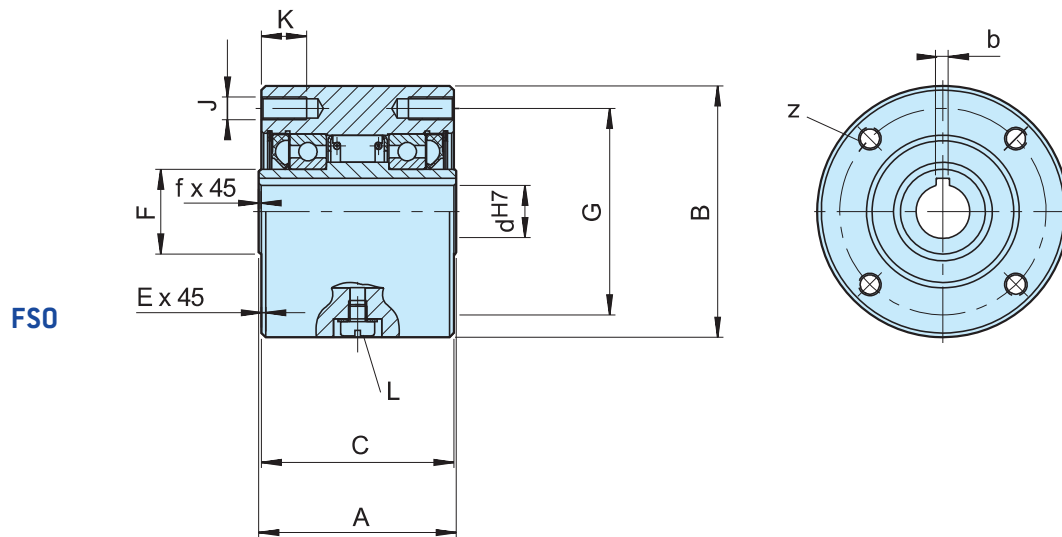

| Type | Size | Overrunning speeds | | | | | | | | | | | | | | | Lubricant | | | Weight | Drag torque | | |
|----------------------|------|---------------------------------------|--|--|-----------------|----------|--------|---------|--------|-----|---------------------|--------|----|------|----|----|-----------|---------|-----|--------|-------------|----------------|--|
| | | FSO | FSO-GR | d ^{H7} -bxh | d ⁴⁾ | A | B | C | E | F | G | z | J | K | L | f | FSO | FSO..GR | HPI | | | T _R | |
| | | T _{KN} ¹⁾ [Nm] | n _{max} ²⁾ [min ⁻¹] | n _{max} ³⁾ [min ⁻¹] | | min-max | | -0,05 | | | | | | | | | | | | | | | |
| FSO FSO-GR HPI | 300 | 379 | 3000/900 | 3600/900 | 15-5x5 | 12... 19 | 63,50 | 76,20 | 60,45 | 1,6 | 28,58 | 66,67 | 4 | M8 | 13 | M6 | 0,8 | 7 | 10 | 14 | 1,6 | 18 | |
| | 400 | 407 | 2800/850 | 3600/850 | 18-6x6 | 12... 22 | 69,85 | 88,90 | 68,07 | 1,6 | 30 | 73 | 4 | M8 | 13 | M6 | 0,8 | 10 | 20 | 20 | 2,7 | 27 | |
| | 500 | 1621 | 2500/800 | 3000/800 | 30-8x7 | 19... 33 | 88,90 | 107,95 | 85,73 | 1,6 | 45 | 92 | 4 | M8 | 16 | M6 | 1,5 | 22 | 35 | 35 | 4,8 | 31 | |
| | 600 | 3105 | 2200/750 | 2400/750 | 40-12x8 | 24... 57 | 95,25 | 136,525 | 92,2 | 1,6 | 63,5 | 120,6 | 6 | M8 | 16 | M6 | 1,6 | 52 | 84 | 84 | 8,6 | 62 | |
| | | | | | | 45-14x9 | | | | | | | | | | | | | | | | | |
| | | | | | | 50-14x6 | | | | | | | | | | | | | | | | | |
| | | | | | | 50-14x9 | | | | | | | | | | | | | | | | | |
| | 700 | 6900 | 1600/450 | 2000/450 | 60-18x11 | 48... 82 | 127,00 | 180,975 | 123,85 | 1,6 | 90 | 158,75 | 8* | M10* | 20 | M6 | 1,6 | 168 | 280 | 280 | 19 | 156 | |
| | | | | | 65-18x11 | | | | | | | | | | | | | | | | | | |
| | | | | | 70-20x12 | | | | | | 101,6 ⁵⁾ | | | | | | | | | | | | |

NOTES

- 1) $T_{max} = 2 \times T_{KN}$
» Refer to Selection page 10 to 13
 - 2) Inner race/outer raceg
 - 3) Inner race/outer race labyrinth seal
 - 4) Inch bore available on request
 - 5) Only for oversize bore
Size 600 > 50 mm
Size 700 > 75 mm
 - * 6 holes equally spaced at 60° plus
2 extra-holes at 180°
- » Refer to mounting and maintenance instructions
page 16 to 19

EMOUNTING EXAMPLE

